

FORM NO 1.

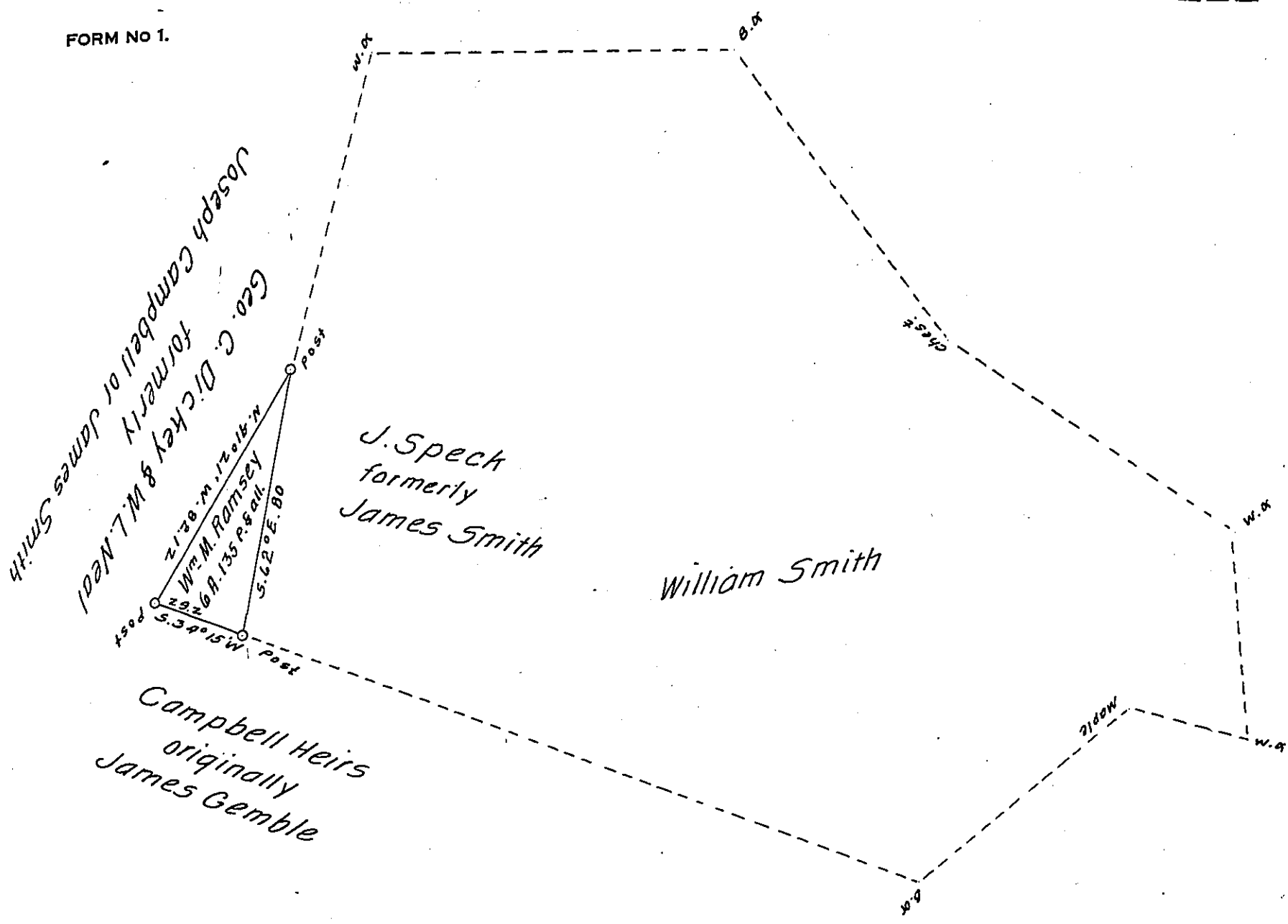

A Draft of a tract of land situated in the Township of Centre and County of Indiana, containing Six acres, 135 perches and allowance of six per cent. for roads, etc. Surveyed for Geo. C. Dickey & W. L. Neal the First day of January 1903, it being part of a larger tract containing 273 acres, — perches and allowance, originally surveyed in pursuance of a warrant granted to W^m Smith dated the 14th day of August 1774.

To James W. Latta, Esq, } D. L. Moorhead
 Secretary of Internal Affairs } County Surveyor

Note.-When this form is used the County Surveyor should indicate by dotted lines the remainder of the original survey, thus showing the location of the part returned. See paragraph nine of instructions to County Surveyors.

IN TESTIMONY that the above is a copy of the original remaining on file in the Department of Internal Affairs of Pennsylvania, made conformably to an Act of Assembly approved the 16th day of February, 1833, I have hereunto set my Hand and caused the Seal of said Department to be affixed at Harrisburg, this third day of September 1907.

Henry Houck
 Secretary of Internal Affairs.